



**Model : 288-SS**

## BALL VALVE (2-PC)

*Stainless steel*

Blow-out proof stem / Full bore  
 Investment casting body 800PSI (55 Bar W.O.G)  
 /1000PSI (69 Bar W.O.G)  
 Material : ASTM-CF8M A351

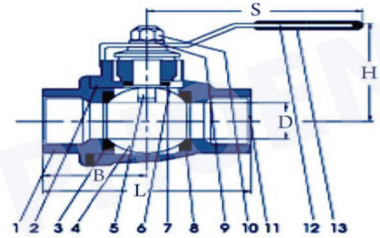
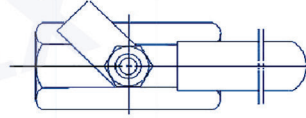

### Materials

NO.	Parts	Materials
1.	CAP	SUS316
2.	Joint Gasket	Teflon
3.	Seat	PTFE (RTFE)
4.	Ball	SUS316
5.	Stem	SUS316
6.	Thrust Washer	Teflon
7.	Stem Packing	Teflon
8.	Gland Nut	SUS304
9.	Stem Washer	SUS304
10.	Stem Nut	SUS304
11.	Body	SUS316
12.	Handle	SUS304
13.	Plastic Cover	Plastic

**PRESSURE / TEMPERATURE RATING**

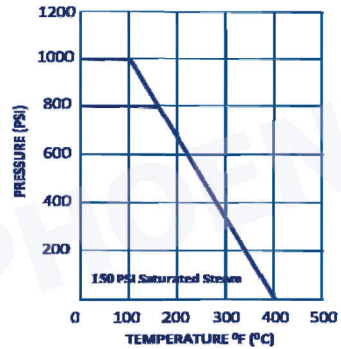

### Dimension

mm

Size	D	B	L	D	S	Wt(kg)
1/4	11.6	23.4	46.8	48.0	103.0	0.20
3/8	11.6	24.2	48.5	48.0	103.0	0.25
1/2	15.0	29.0	58.0	52.0	103.0	0.30
3/4	20.0	32.5	65.0	61.0	123.0	0.35
1	25.0	38.5	77.0	65.0	123.0	0.65
1 1/4	32.0	45.0	90.0	79.0	153.0	1.05
1 1/2	38.0	49.0	98.0	83.0	153.0	1.35
2	50.0	60.5	121.0	97.0	185.0	2.51
2 1/2	65.0	72.5	145.0	135.0	243.0	5.00
3	80.0	83.0	166.0	144.0	243.0	7.65